

## OIL AND LUBRICATION SYSTEMS

*Oil and lubrication systems*



# LUBRICATION SYSTEMS

**So that everything runs smoothly**

One of our aims is to make the lifetime of your plants as long as possible. Our lubrication systems provide you with a competitively priced solution that makes an important contribution to achieving this goal.

Murtfeldt lubrication systems constitute a perfected combination of sound technology, reliable functioning, and cost effectiveness.

**To meet your requirements completely – both for manual and automatic lubrication**

The architecture and structure of your plants dictates whether manual or automatic lubrication systems are best. While manual units have to be opened or closed by the operator, automatic systems are electronically controlled by the plant itself. You can choose between a manual lubrication system, an automatic lubrication system, a central lubrication unit with a pump, or an automatic spray system. All of our systems have optimum dosing capability, good visual control of drippage, and a choice of Plexiglas or natural glass cylinders.



Murtfeldt lubrication systems benefit from our many years of experience in drip lubrication. Each design exactly fulfils its purpose. We are happy to advise you regarding your choice of suitable product.

## TYPE UNI

Stained brass

- Open + close function
- Large filling tray with dust cover
- Suitable for one lubricating point
- Precise drip dosing via regulating spindle
- Good visual control of dripage

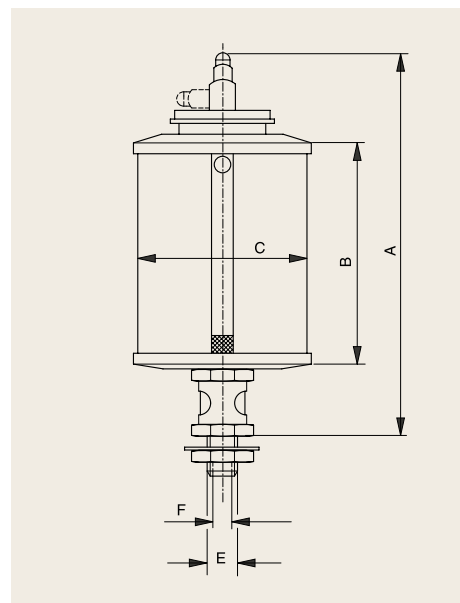

Type	Thread E/F	A*	B*	C*	Capacity	Plexiglas article no.	Natural glass article no.
UNI 25	G 1/4" - ø 4	72	28	25	10ml	311 200 001	311 200 023
UNI 30	G 1/4" - ø 4	77	30	30	20ml	311 200 002	311 200 012
UNI 40	G 1/4" - ø 4	100	40	40	36ml	311 200 003	-
UNI 50	G 1/4" - ø 4	110	50	50	84ml	311 200 004	311 200 013
UNI 60	G 1/4" - ø 4	120	60	60	140ml	311 200 005	311 200 014
UNI 60 x 80	G 1/4" - ø 4	140	80	60	200ml	311 200 006	311 200 015
UNI 80 x 100	G 1/2" - IG 1/4"	160	100	80	500ml	311 200 007	311 200 016
UNI 100 x 100	G 1/2" - IG 1/4"	185	100	100	750ml	311 200 008	311 200 017
UNI 100 x 120	G 1/2" - IG 1/4"	195	120	100	1000ml	311 200 009	311 200 018
UNI 130 x 150	G 1/2" - IG 1/4"	240	150	130	2000ml	311 200 010	311 200 019
UNI 150 x 180	G 1/2" - IG 1/4"	270	180	150	3000ml	311 200 011	311 200 020

\* All dimensions in mm

## TYPE MOS

### Stained brass

- Open + close function via shut-off valve
- Medium dosing via additional oil dispenser type ETR and MTR

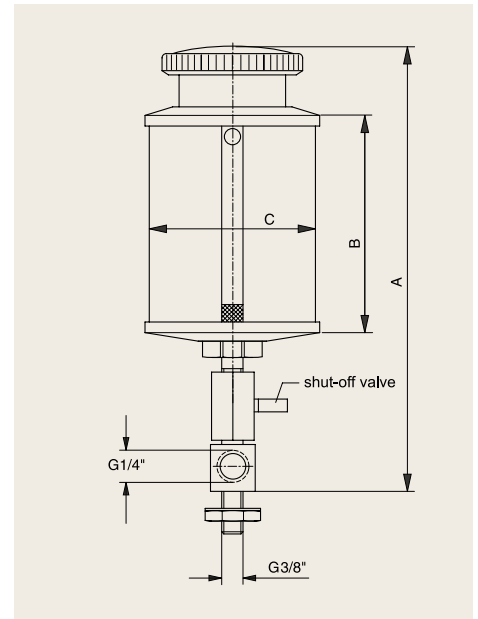

Type	A*	B*	C*	Capacity	Plexiglas article no.	Natural glass article no.
MOS 140	165	60	60	140ml	311 300 001	311 300 002
MOS 200	185	80	60	200ml	311 300 003	311 300 004
MOS 500	220	100	80	500ml	311 300 005	311 300 006
MOS 1000	240	120	100	1000ml	311 300 007	311 300 008
MOS 2000	295	150	133	2000ml	311 300 009	311 300 010
MOS 3000	315	180	150	3000ml	311 300 011	311 300 012

\* All dimensions in mm

## TYPE MTM

### Stained brass

- Open + close function via shut-off valve
- Distributor battery (2 to 12 oil dispensers) with regulating spindle for precise drip dosing
- Good visual control of dripage
- Dosing possible for each individual lubricating point

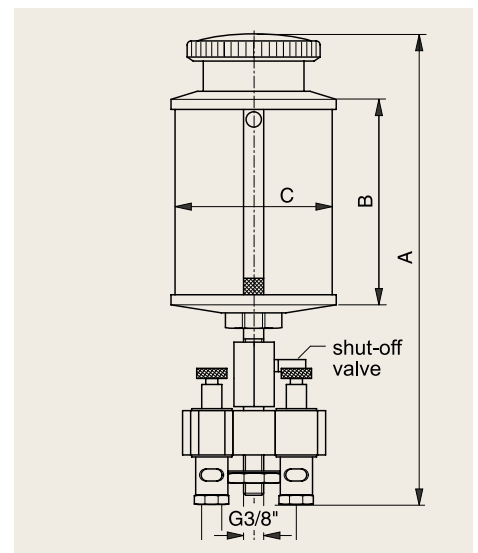

Type	A*	B*	C*	Capacity	Plexiglas article no.	Natural glass article no.
MTM 140/2	195	60	60	140ml	311 400 001	311 400 002
MTM 200/2	215	80	60	200ml	311 400 003	311 400 004
MTM 500/2	250	100	80	500ml	311 400 005	311 400 006
MTM 1000/2	270	120	100	1000ml	311 400 007	311 400 008
MTM 2000/2	305	150	133	2000ml	311 400 009	311 400 010
MTM 3000/2	345	180	150	3000ml	311 400 011	311 400 012
Add-on lubricating point					312 200 009	312 200 010

\* All dimensions in mm

The minimum adjustment possibility is one to two drips per minute. 45 drips correspond approx. 1 ml of lubricant.

Unlike manual systems, the open + close function of automatic lubrication systems is regulated electronically. This is done either via the existing machine control unit or via a freely programmable impulse generator. The systems guarantee the optimum dosing of the oil reservoir.

## ELECTRICAL CONNECTIONS

### Standard designs for automatic lubrication systems

230V/50Hz	230V/60Hz	110V/50Hz	48V/50Hz	24V/50Hz	24V/60Hz	24V/DC	12V/DC
-----------	-----------	-----------	----------	----------	----------	--------	--------

## TYPE ELO

### Nickel-plated brass

- Suitable for one lubricating point
- Filling tray with dust cover
- Precise drip dosing via regulating spindle
- Good visual control of drippage

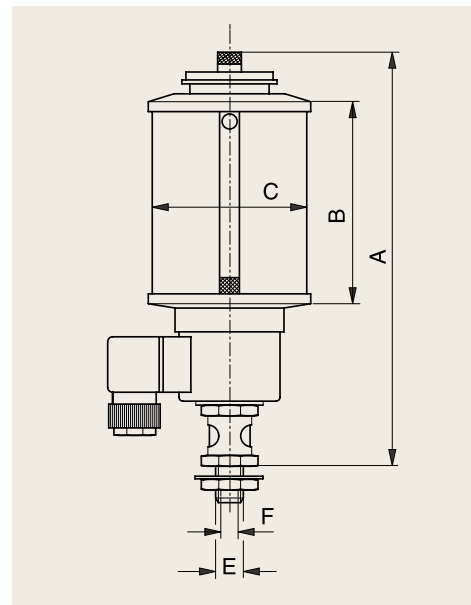

Type	Thread E	Thread F	A*	B*	C*	D*	Capacity	Plexiglas article no.	Natural glass article no.
ELO 140	G 1/2"	G 1/4"	150	60	60	15	140ml	311 500 009	311 500 017
ELO 200	G 1/2"	G 1/4"	170	80	60	15	200ml	311 500 025	311 500 033
ELO 500	G 1/2"	G 1/4"	200	100	80	15	500ml	311 500 041	311 500 049
ELO 1000	G 1/2"	G 1/4"	240	120	100	15	1000ml	311 500 057	311 500 065
ELO 2000	G 1/2"	G 1/4"	285	150	133	15	2000ml	311 500 073	311 500 081
ELO 3000	G 1/2"	G 1/4"	315	180	150	15	3000ml	311 500 089	311 500 097

Protection class: In accordance with DIN 40050 IP 20  
 Duty cycle: 50% (max. 4 hours continuous with RT)  
 Required nominal power: 12VA (for ELO 40 5VA)  
 Number of drips: approx. 45 drips on 1 ml

\* All dimensions in mm

\*\* Article numbers apply for 230V, 50Hz.  
 If a different voltage is required, state your specifications.

## TYPE EOS-B

### Nickel-plated/stained brass

- Electrical lubricator for 1 – 12 lubricating points in a single line design
- Dosing via separate drip-feed lubricators type ETR or MTR
- Large filling tray with screw cap/tank cap

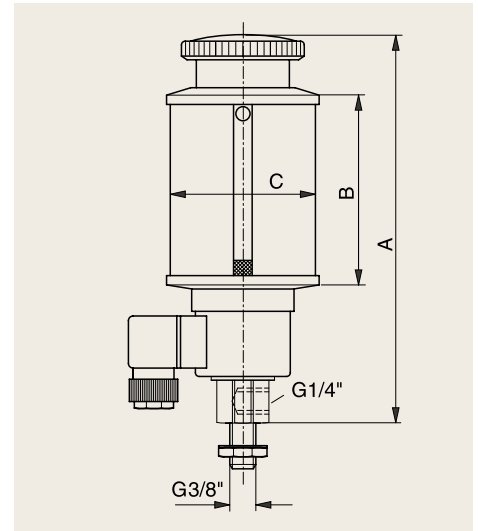

Type	A*	B*	C*	Capacity	Cap	Plexiglas article no.	Natural glass article no.
EOS-B 140	150	60	60	140ml	Screw	311 600 001	311 600 009
EOS-B 200	170	80	60	200ml	Screw	311 600 017	311 600 025
EOS-B 500	210	100	80	500ml	Tank	311 600 033	311 600 041
EOS-B 1000	250	120	100	1000ml	Tank	311 600 049	311 600 057
EOS-B 2000	295	150	133	2000ml	Tank	311 600 065	311 600 073
EOS-B 3000	325	180	150	3000ml	Tank	311 600 081	311 600 089

Protection class: In accordance with DIN 40050 IP 20  
 Duty cycle: 50% (max. 4 hours continuous with RT)  
 Required nominal power: 14VA

\* All dimensions in mm.

Article numbers apply for 230V, 50Hz.  
 If a different voltage is required, state your specifications.

## TYPE EOS-H

### Nickel-plated/stained brass

Same function as EOS-B

- Higher solenoid valve protection class
- Can be used in humid conditions and with dust exposure
- Available with 5,000 and 9,000ml aluminium oil reservoir

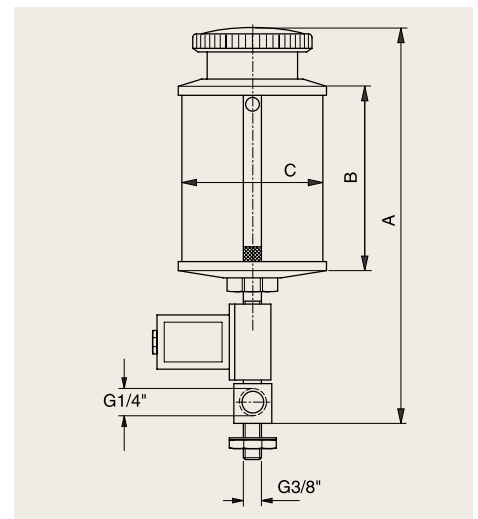

Type	A*	B*	C*	Capacity	Cap	Plexiglas article no.	Natural glass article no.
EOS-H 140	170	60	60	140ml	Screw	311 700 001	311 700 009
EOS-H 200	190	80	60	200ml	Screw	311 700 017	311 700 025
EOS-H 500	225	100	80	500ml	Tank	311 700 033	311 700 041
EOS-H 1000	245	120	100	1000ml	Tank	311 700 049	311 700 057
EOS-H 2000	280	150	133	2000ml	Tank	311 700 065	311 700 073
EOS-H 3000	320	180	150	3000ml	Tank	311 700 081	311 700 089

Protection class: In accordance with DIN 40050 IP 65. Duty cycle: 100%  
 Required nominal power: 8VA

Also available in protection Exs G4 (with 3m pressed cable).  
 \* All dimensions in mm

Article numbers apply for 230V, 50Hz.  
 If a different voltage is required, state your specifications.

# TYPE MET-B

Nickel-plated/stained brass

- 2 – 10 lubricating points design
- Drip dosing right on lubricant container
- Individual lubricating point dosing via regulating spindle
- Filling tray with screw cap/tank cap
- Good visual control of drippage

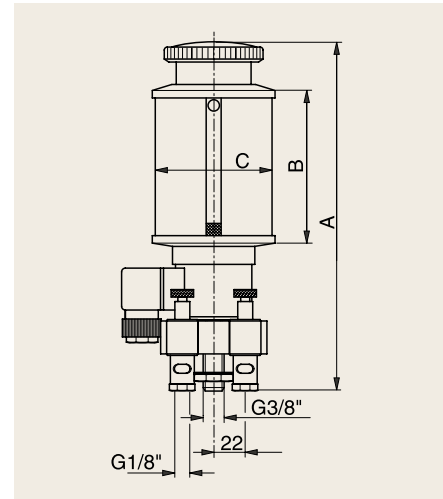

Type	A*	B*	C*	Capacity	Cap	Plexiglas article no.	Natural glass article no.
MET-B 140/2	175	60	60	140ml	Screw	311 800 001	311 800 018
MET-B 200/2	195	80	60	200ml	Screw	311 800 062	311 800 013
MET-B 500/2	235	100	80	500ml	Tank	311 800 052	311 800 009
MET-B 1000/2	275	120	100	1000ml	Tank	311 800 053	311 800 097
MET-B 2000/2	320	150	133	2000ml	Tank	311 800 043	311 800 090
MET-B 3000/2	350	180	150	3000ml	Tank	311 800 081	311 800 111
Add-on lubricating point						312 200 009	312 200 010

Protection class: In accordance with DIN 40050 IP 20  
 Duty cycle: 50% (max. 4 hours continuous with RT)  
 Required nominal power: 14VA

\* All dimensions in mm | The minimum adjustment possibility is one to two drips per minute. 45 drips correspond approx. 1 ml of lubricant.

Article numbers apply for 230V, 50Hz. If a different voltage is required, state your specifications.

# TYPE MET-H

Nickel-plated/stained brass

Same function as MET-B

- Higher solenoid valve protection class
- Can be used in humid conditions and with dust exposure
- Available with 5,000 and 9,000ml aluminium oil reservoir

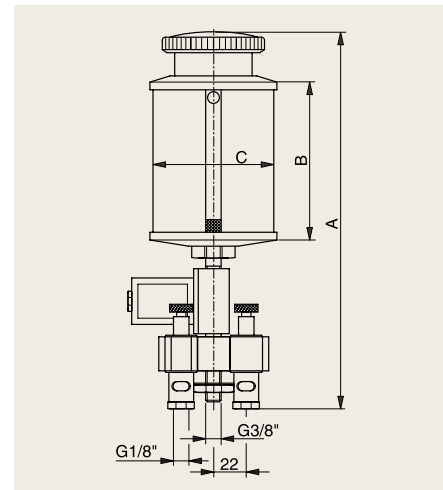

Type	A*	B*	C*	Capacity	Cap	Plexiglas article no.	Natural glass article no.
MET-H 140/2	200	60	60	140ml	Screw	311 900 001	311 900 009
MET-H 200/2	220	80	60	200ml	Screw	311 900 017	311 900 025
MET-H 500/2	255	100	80	500ml	Tank	311 900 033	311 900 041
MET-H 1000/2	275	120	100	1000ml	Tank	311 900 049	311 900 057
MET-H 2000/2	310	150	133	2000ml	Tank	311 900 065	311 900 073
MET-H 3000/2	350	180	150	3000ml	Tank	311 900 081	311 900 089
Add-on lubricating point						312 200 009	312 200 010

Protection class: In accordance with DIN 40050 IP 65. Duty cycle: 100% | Required nominal power: 8VA | Also available in protection class Exs G4 (with 3m pressed cable).

\* All dimensions in mm | The minimum adjustment possibility is one to two drips per minute. 45 drips correspond approx. 1 ml of lubricant.

Article numbers apply for 230V, 50Hz. If a different voltage is required, state your specifications.



# MTM/MET SYSTEM STRUCTURE

Line diagram with PVC hose or PA 12W hose

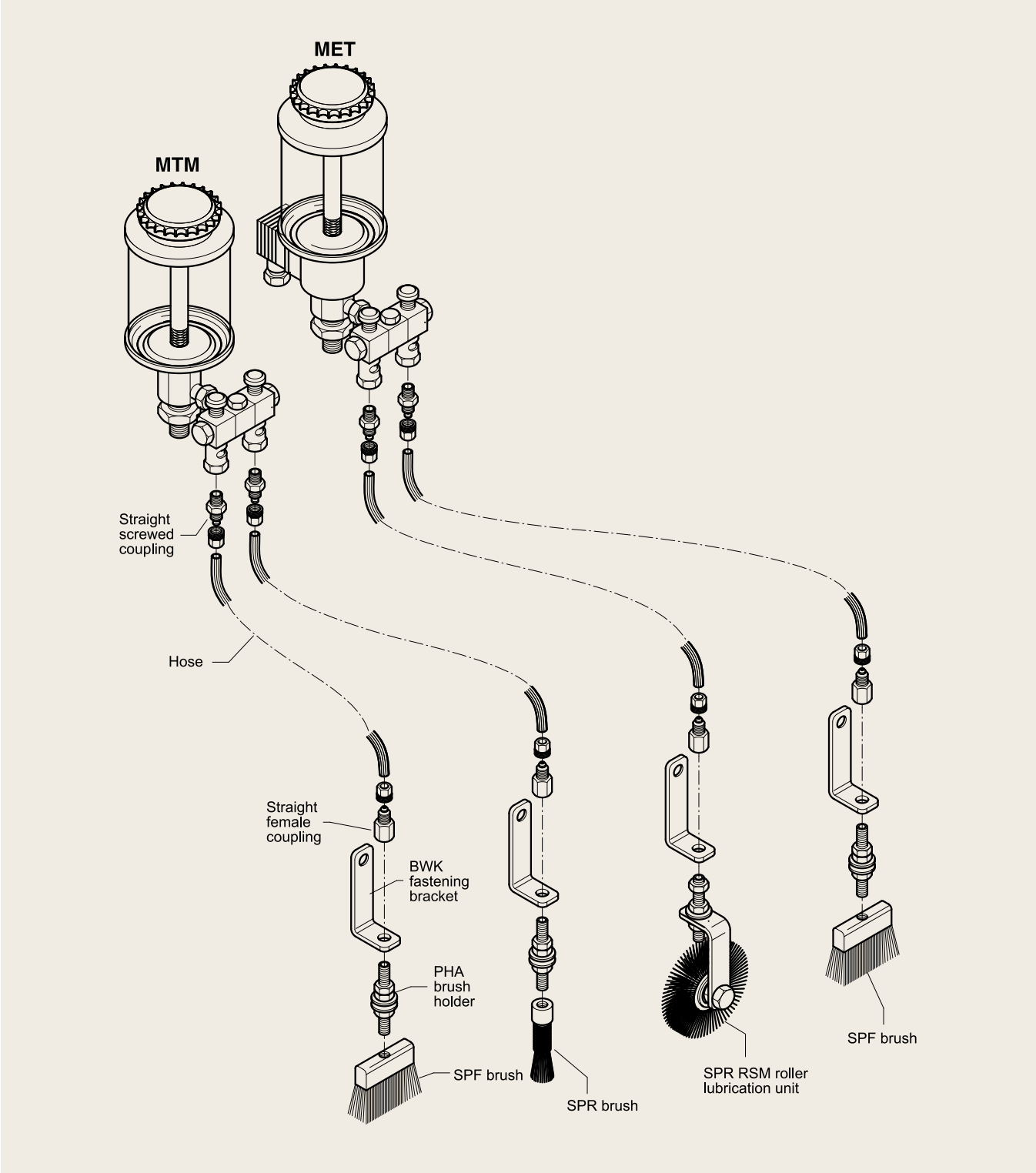

# MOS/EOS SYSTEM STRUCTURE

Line diagram with PVC hose or PA 12W hose

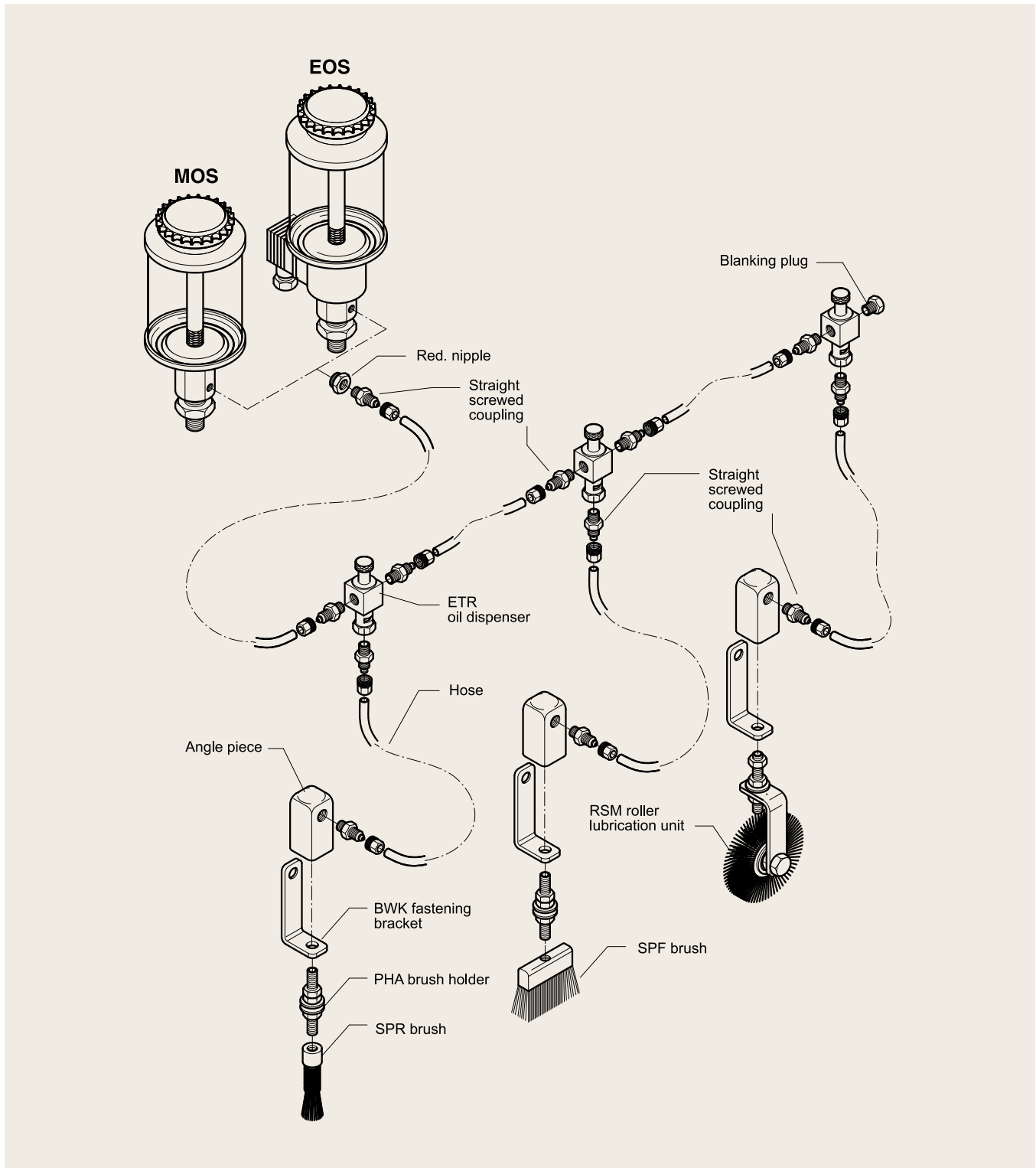

# TYPE EPO 500 TO 9000

## Central lubrication unit with pump

The EPO central lubrication unit consists of an electric pump, butterfly valve, and storage tank. The pump is designed for single-line operation; multiple pumps (multi-line operation) can easily be attached if using 5l and 9l reservoirs. To prevent the unit from running dry, you can opt for a reservoir with an electronic type SMM fill level display. We also recommend the installation of non-return valves to prevent the riser pipe from draining following the completion of the pump process.

- Storage tank: 0.5 – 9 Liter capacity
- EPO 500 – 3000: Plexiglas or natural glass (for single-line operation)
- EPO 5000 – 9000: Aluminium (single- and multi-line operation)
- Pump pressure: 1.5bar
- Recommended oil viscosity:  $\leq 65 \text{ mm}^2/\text{s}$  at room temperature
- Oil distribution via oil dispenser type ETR and MTR
- Pump control via machine control unit or freely programmable timer

EPO 500 to 3000

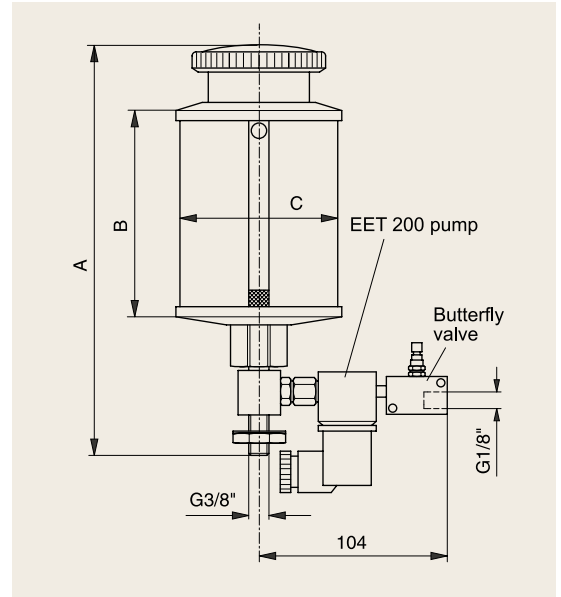

EPO 5000 to 9000

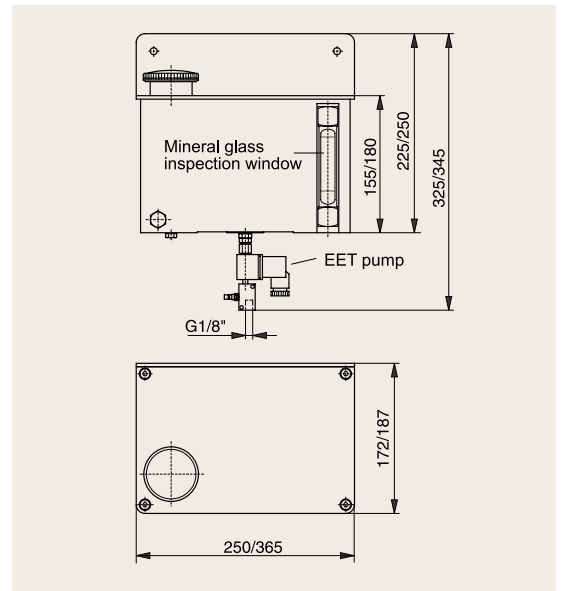

Type	A*	B*	C*	Capacity	Plexiglas article no.
EPO 500	180	100	80	500ml	312 000 001
EPO 1000	200	120	100	1000ml	312 000 002
EPO 2000	235	150	133	2000ml	312 000 003
EPO 3000	300	180	150	3000ml	312 000 004
EPO 5000	See drawing for dimensions			5000ml	312 000 005
EPO 9000	See drawing for dimensions			9000ml	312 000 006

Electrical connection: 230V 50Hz / protection class: IP 65

\* All dimensions in mm

# EPO CENTRAL LUBRICATION UNIT SYSTEM STRUCTURE

For single-line operation

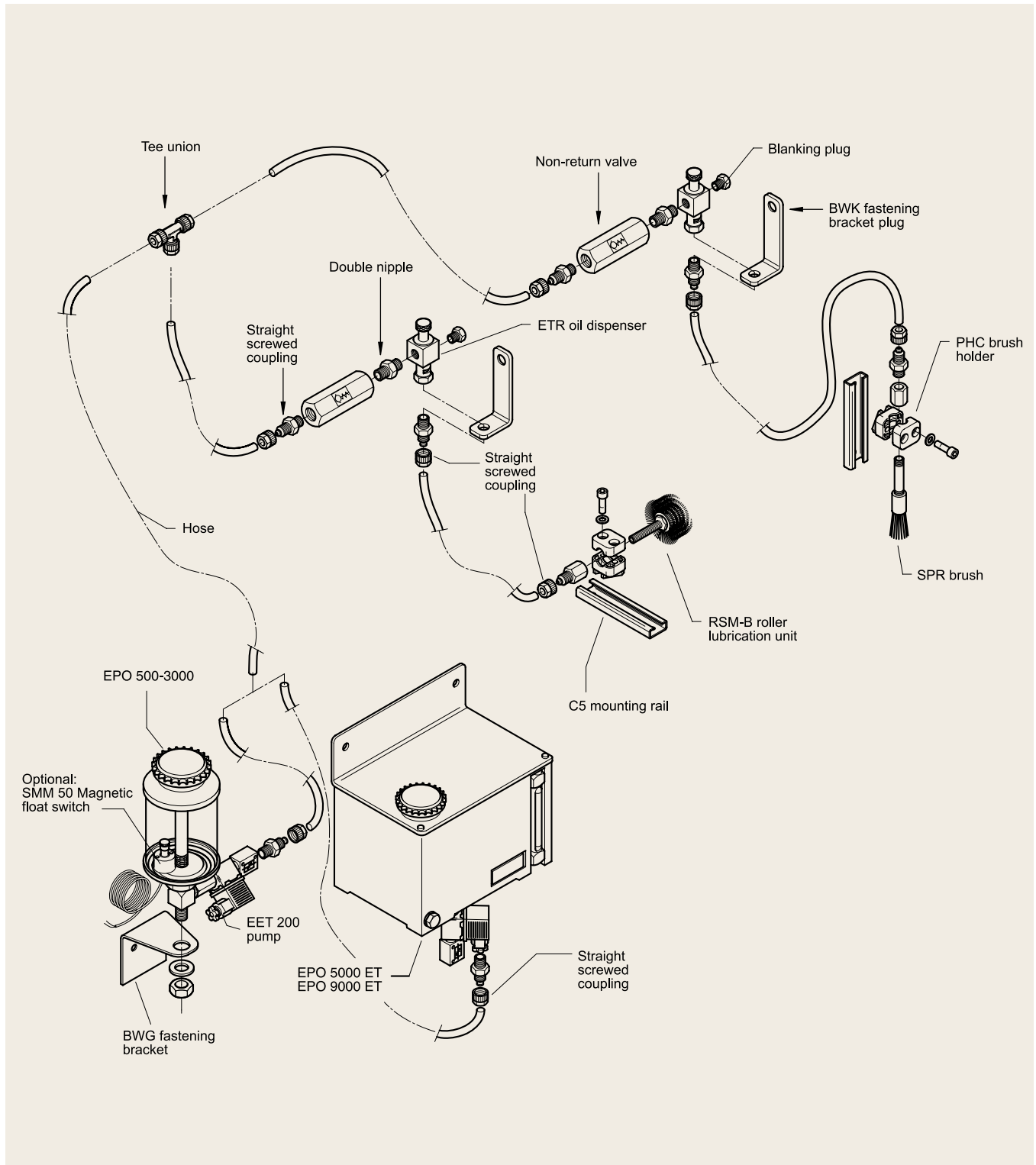

# CABLE ROUTING DIAGRAM WITH COPPER PIPE

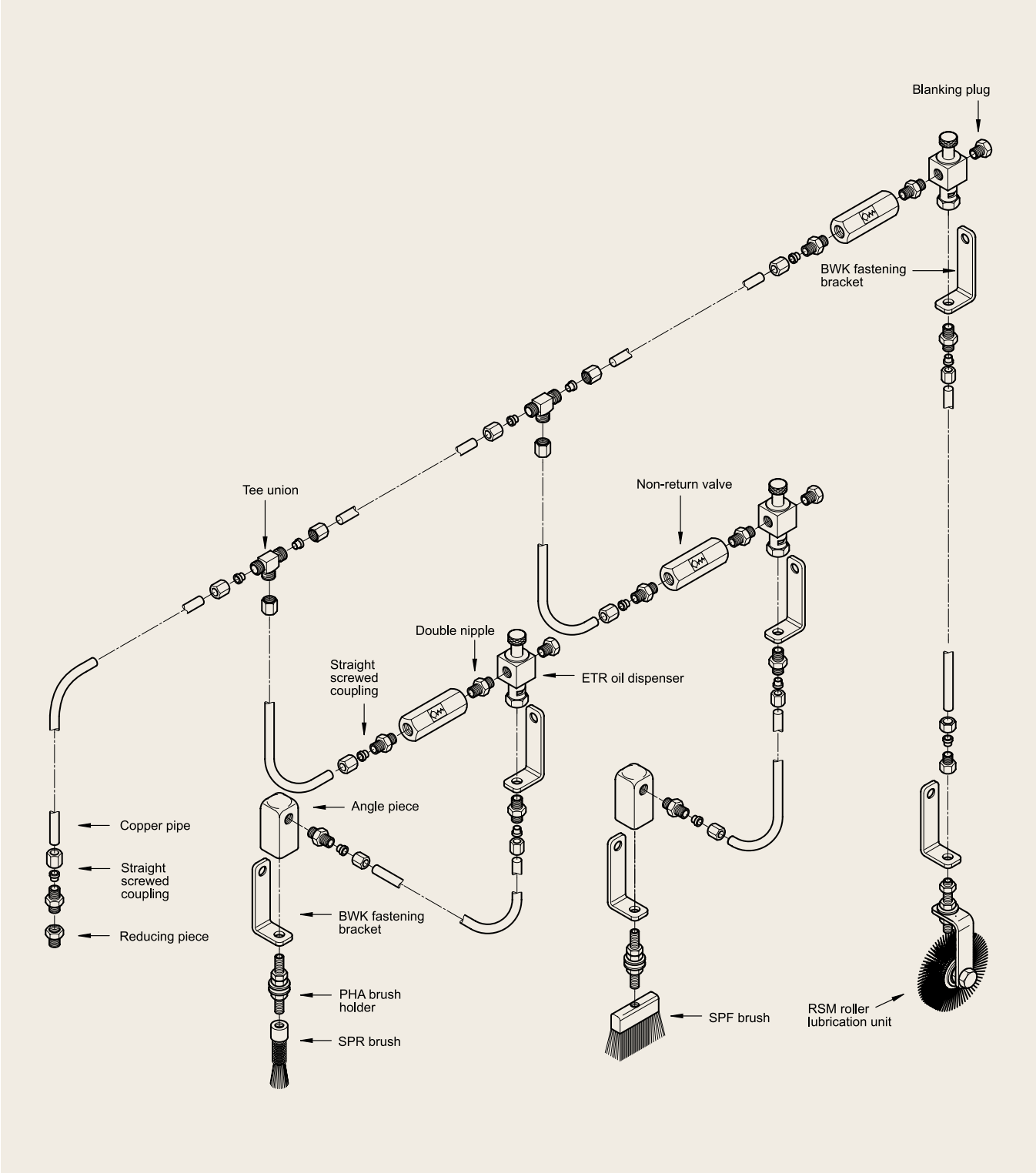

# TYPE EET 200

Electric pump – article no. 312 100 001

- Brass pump casing
- For single-line operation
- Supplies fluids at a pressure of 1.5bar intermittently at height of ~10m
- Controlled via existing plant control unit or via freely programmable timer (type 1078/1 AL)

### RESPONSE TIMES

- 'On' time 0.5 to 90s (t off ≥ t on/  
'off' time = 'on' time)
- 'On' time 90 to 150s (t off ≥ 2 x t on)

### FURTHER TECHNICAL DATA

- Power: 29VA
- Protection class: IP 65
- Ambient temperature: ≤ 40°C
- Operating pressure: ≤ 1.5 bar
- Supply rate: 21 cm<sup>3</sup>/min;  
for oil: 65mm<sup>2</sup>/s
- Turn on time: max. 150s
- Maximum recommended viscosity:  
65mm<sup>2</sup>/s at room temperature
- Electrical connection: 230V, 50Hz

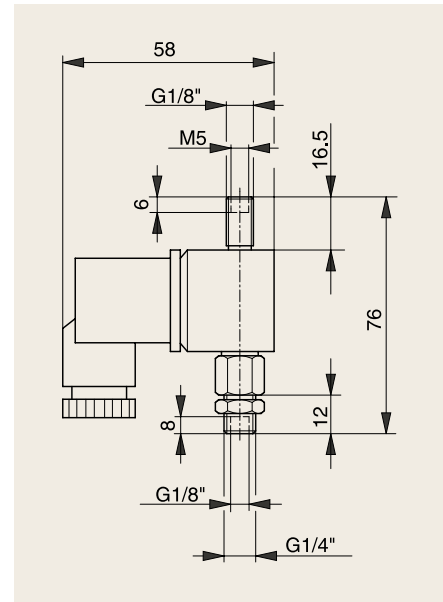

# TYPE EET 300/6

Electric pump – article no. 312 100 002

- Electromagnetic reciprocating plunger type pump
- For continuous and non-continuous operation
- Controlled via existing plant control unit or via freely programmable timer (type 1078/1)
- Integrated thermal element to prevent overheating
- Integrated rectifier diode
- Low-noise system

### FURTHER TECHNICAL DATA

- Power: 60W
- Protection class: IP 65
- Operating pressure: ≤ 6bar in continuous or non-continuous operation
- Suction height ≤ 4m
- Turn on time: Full turn on time (several hours)
- Electrical connection: 230V, 50Hz
- Maximum recommended viscosity of supplied medium: 300mm<sup>2</sup>/s

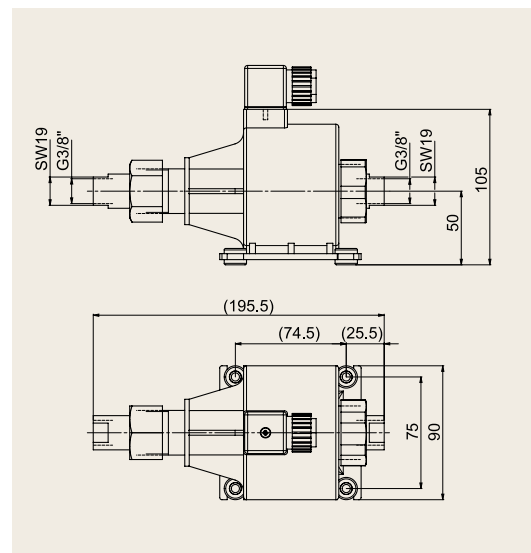

### Data for 6mm<sup>2</sup>/s viscosity

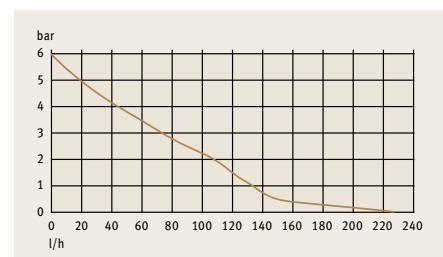

# UNI MICROSPRAY I

## Minimum use of lubricant – maximum effect

UNI Microspray I has significant advantages when compared to traditional brush lubrication systems. It enables the stepless regulation of the spray quantity. The directed spray can reach places that are out of the range of brush lubrication systems.

Both oil consumption and the contamination of the surrounding area are considerably lower in comparison with drip lubrication systems. We can configure an individual, perfectly adapted Microspray system for every single lubrication scenario. Even if the coaxial hose is mounted at an angle, the oil flow cannot become blocked since the lubrication media are transported in separate hoses. The mixing takes place in the spray head itself.

- Lubrication of chain knot points/ crossovers with central spray system
- Lubricant: Sprayable oils and bio degradable fatty alcohols/fatty acid ester to 120mm<sup>2</sup>/s
- Distance between dosing unit casing and spray head: ≤ 10m
- Compressed air in pipes: 2 – 16bar
- Stepless and reproducible adjustment of high-pressure plunger pump (~ 80bar) possible

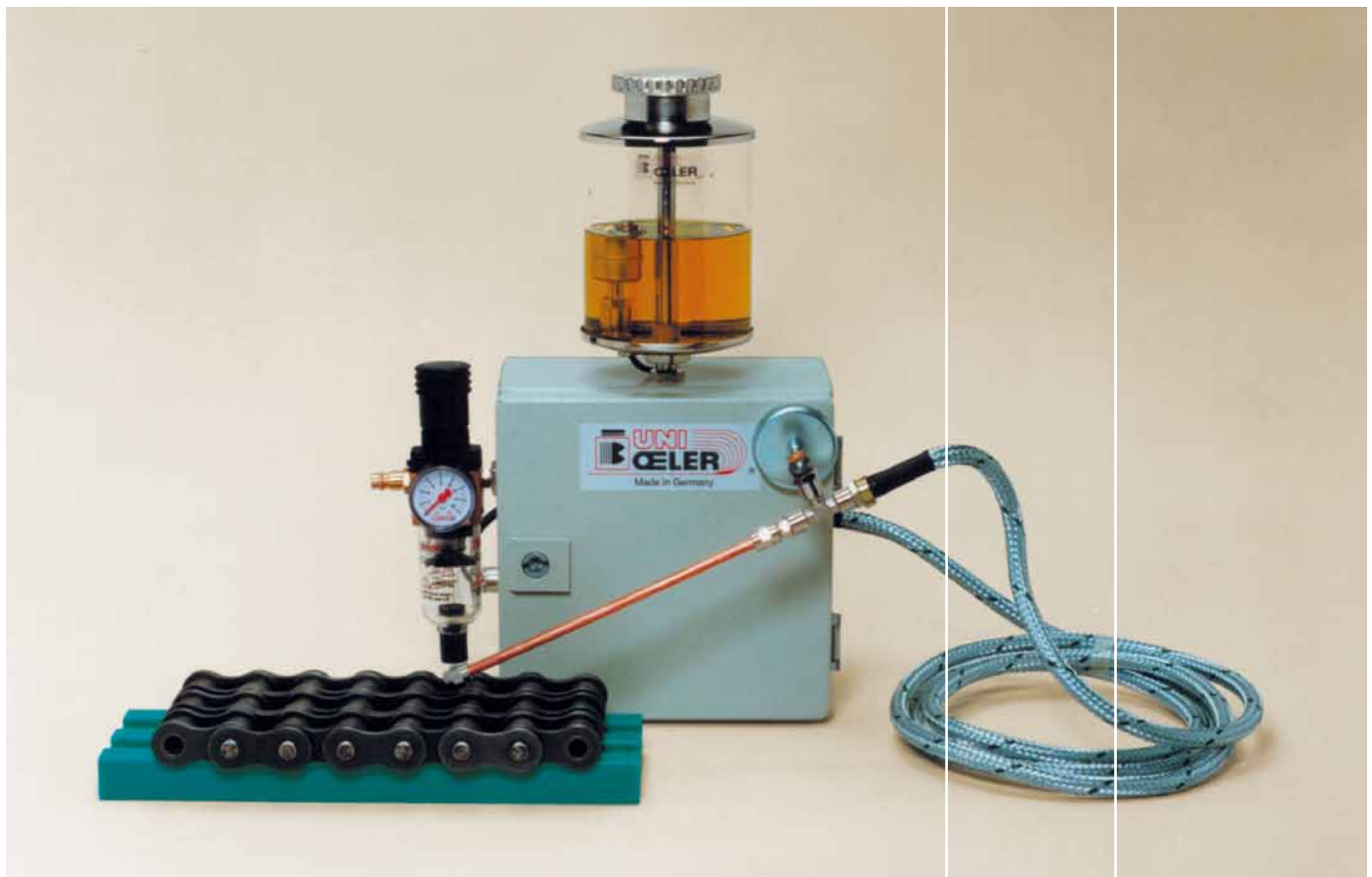
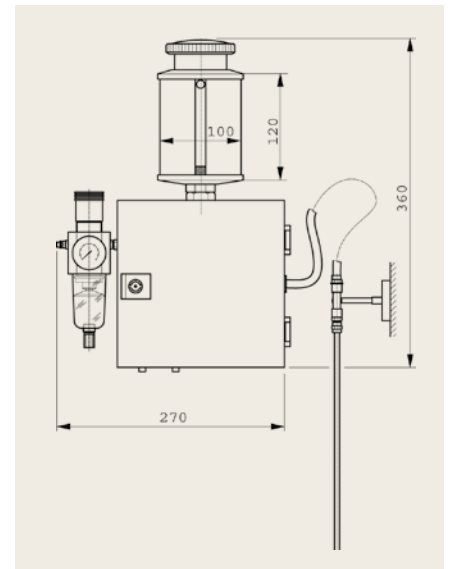

## Design variants

### ALL MICROSPRAY-I-VERSIONS

■ Plexiglas oil reservoir

■ Capacity: 1000ml

■ Electrical connection: 230V,  
50Hz, 5VA

#### VERSION 1 / Art. no. 313 800 001

■ Protection class IP 65 incl.  
1 pneumatic impulse generator

■ 1 pump

■ 2.5m metal-clad coaxial hose  
with nozzle pipe

#### VERSION 2 / Art. no. 313 800 002

■ Protection class IP 65 incl.  
1 pneumatic impulse generator

■ 2 pumps

■ 2 x 2.5m metal-clad coaxial  
hoses with nozzle pipe

#### VERSION 3 / Art. no. 313 800 003

■ Protection class IP 65 incl.  
2 pneumatic impulse generators

■ 2 pumps

■ 2 x 2.5m metal-clad coaxial  
hoses with nozzle pipe

- 1 Lubricant reservoir
- 2 Casing (sealable)
- 3 Lubricant hose
- 4 Spray hose
- 5 Metal-clad coaxial hose
- 6 Micropump
- 7 Frequency generator
- 8 Pipe air feed
- 9 Solenoid valve
- 10 Nozzle with magnetic baseplate

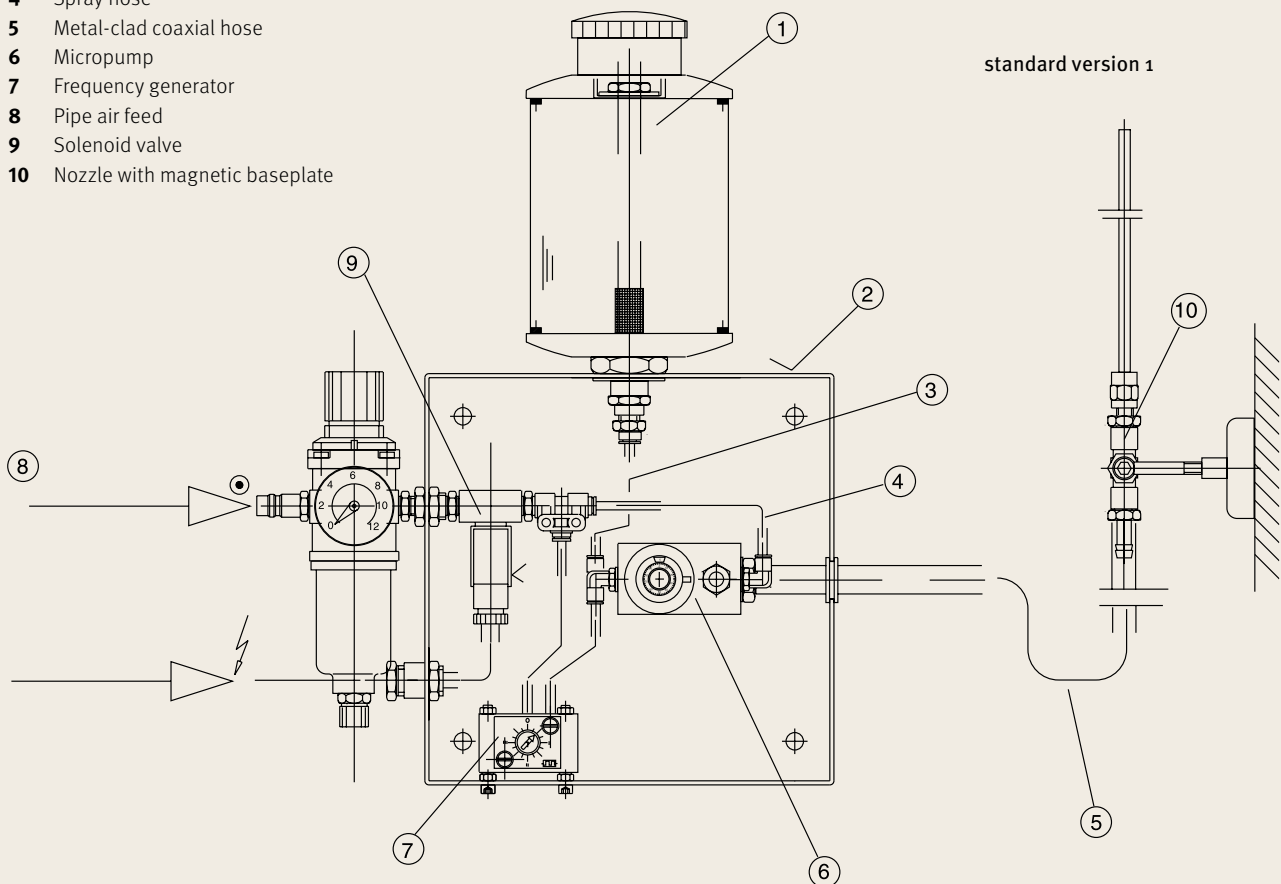



# OIL RESERVOIR TYPE OBH

Nickel-plated brass

- Distribution and dosing possible via downstream oil dispenser type ETR or MTR
- Reservoir model OBH 30 – OBH 3000: Natural glass or Plexiglas
- Reservoir model OBH 5000 und OBH 9000: Aluminium
- Dustproof filling
- NBR seals (other materials available on request)

OBH 14 ml – 3000 ml

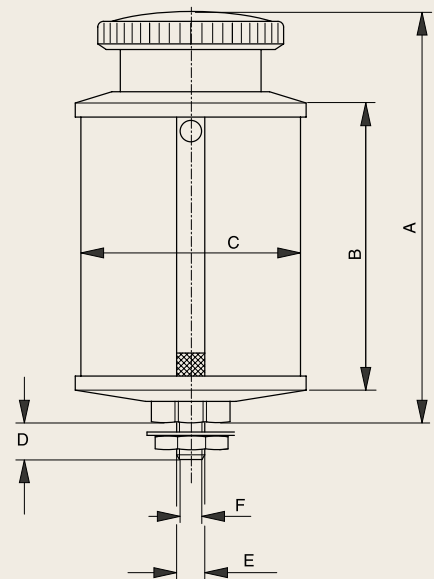

OBH 5000 ml + 9000 ml

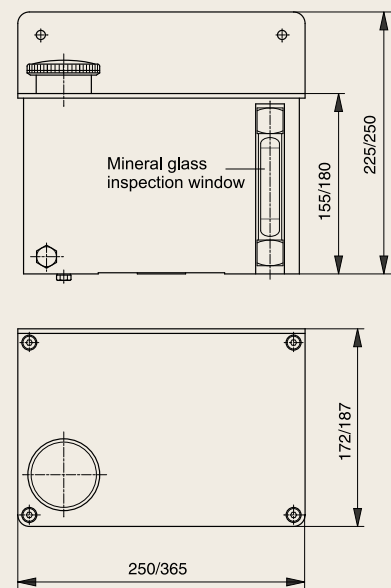

Type	Thread E/F	A*	B*	C*	D*	Capacity	Plexiglas article no.	Natural glass article no.
OBH 30	G 1/4"	56	30	30	7	14ml	313 700 001	313 700 101
OBH 40	G 1/4"	70	40	40	8	36ml	313 700 002	313 700 102
OBH 50	G 1/2"	88	50	50	8	84ml	313 700 003	313 700 103
OBH 140	G 1/2" – IG 1/4"	97	60	60	14	140ml	313 700 004	313 700 104
OBH 200	G 1/2" – IG 1/4"	104	80	60	14	200ml	313 700 005	313 700 105
OBH 500	G 1/2" – IG 1/4"	128	100	80	14	500ml	313 700 006	313 700 106
OBH 1000	G 1/2" – IG 1/4"	148	120	100	14	1000ml	313 700 007	313 700 107
OBH 2000	G 1/2" – IG 1/4"	180	150	133	14	2000ml	313 700 008	313 700 108
OBH 3000	G 1/2" – IG 1/4"	240	180	150	14	3000ml	313 700 009	313 700 109

OBH 5000 AL	IG 3/8"	See drawing for dimensions				5000ml	313 700 201	
OBH 9000 AL	IG 3/8"	See drawing for dimensions				9000ml	313 700 202	

\* All dimensions in mm

# ACCESSORIES FOR ELECTRIC PUMPS

## Butterfly valves

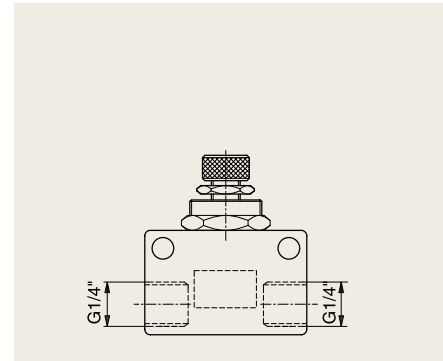
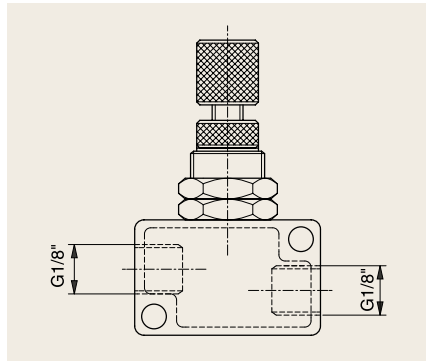

Type	Design	DN	For pump	Screw thread	Article no.
RFO-133-A30-1/8"	Precision cone valve	3	EET 200	G 1/8"	313 900 001
RFO-133-A60-1/4"	Precision slit valve	6	EET 300	G 1/4"	313 900 002

Perbunan seals      Pressure range: 0.2 to 10bar      Temperature range: -20 to +80°C

## Non-return valves

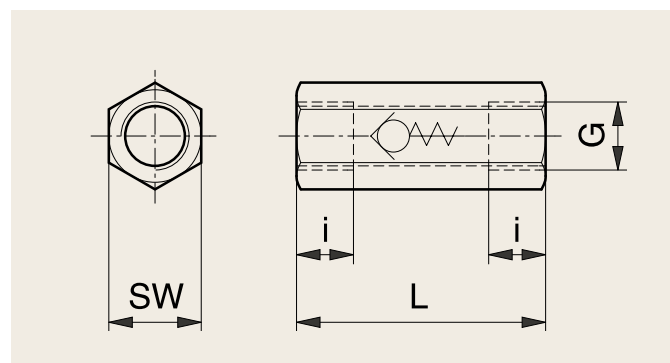

Type	DN	Length L	Thread length i	SW	Screw thread	Seal material	Temperature range	For pump	Article no.
VNR-133-M40-1/8B	4	37	8	13	G 1/8"	Perbunan	-10 – +90°C	EET 200	313 900 101
VNR-133-M40-1/8F	4	37	8	13	G 1/8"	Viton	-10 – +130°C	EET 200	313 900 102
VNR-133-M60-1/4B	6	44	9	17	G 1/4"	Perbunan	-10 – +90°C	EET 300	313 900 103
VNR-133-M60-1/4F	6	44	9	17	G 1/4"	Viton	-10 – +130°C	EET 300	313 900 104

Pressure range: 0.2 to 16bar      Material: Stainless steel balls and springs; Brass 58 nickel-plated valve body

# OIL DISPENSER TYPE ETR 10490/MTR 2-10

## Stained brass

Oil dispensers type ETR and MTR are used throughout machine construction but especially in conveyor and transportation plants. In combination with our manually (MOS) and electrically (EOS) controlled oil applicators, automatic lubrication plants can be configured for practically any usage scenario. The connection of multiple ETR oil dispensers in series enables multiple lubricating points to be provided with lubricant at one time.

### TYPE MTR

- Batteries of multiple oil dispensers with lateral fastening brackets
- Batteries with an uneven number of oil dispensers are possible with an add-on lubricating point

### Type ETR 10490

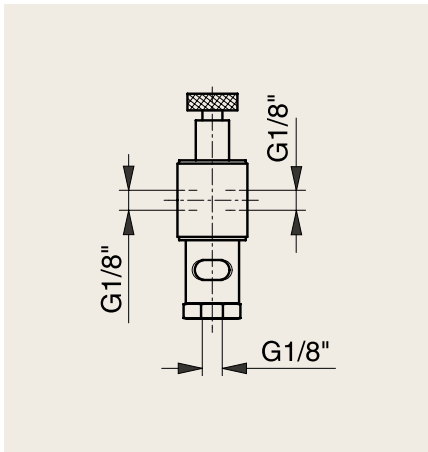

### Type MTR 2 – 10

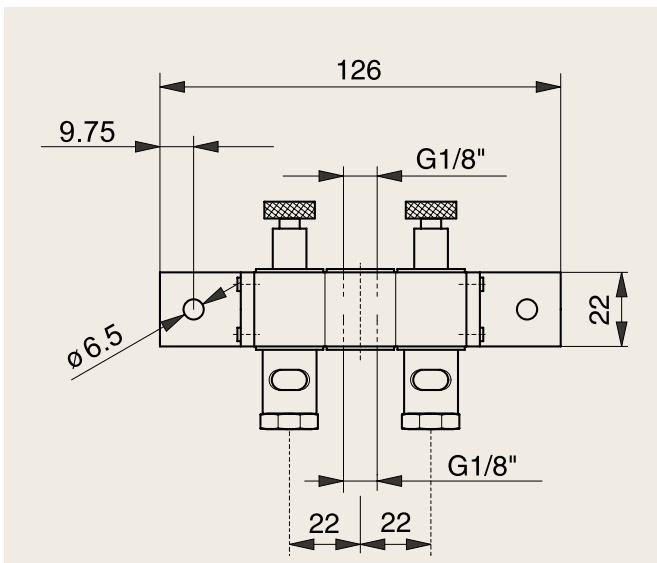

Type	Article no.
ETR	312 200 001
MTR 2	312 300 001
MTR 4	312 300 002
MTR 6	312 300 003
MTR 8	312 300 004
MTR 10	312 300 005
Add-on lubricating point	312 200 009

Inspection window can be delivered in natural glass for all types.  
 The minimum adjustment possibility is one to two drips per minute. 45 drips correspond approx. 1 ml of lubricant.

# ELECTRONIC TIMERS

## Type 1078/1 and Type 1078/1 AL

Our electronic timers act as pulse/impulse generators for automatic lubrication systems (type 1078/1), the EET 300/6 pump (type 1078/1), and central lubrication units (type 1078/1 AL).

- Control components such as time-delay relays, clock relays, SPS, and so on can be replaced
- Flexible cable outlet (90° steps) enables installation even in difficult installation space conditions
- 8-pin DIP switch enables four functions and eight cut-in/off ranges
- Permanent control of supply voltage and valve control via integrated LED display
- Simple assembly: Removal of device socket and insertion of timer type 1078-1
- Splash-proof in accordance with IP 65
- Can be combined with various valves in accordance with DIN 43650



Type	Article no.	Voltage ranges
1078/1	312 400 001	110 – 230V/50 – 60Hz AC
1078/1	312 400 002	24 – 48V/50 – 60Hz AC and DC
1078/1 AL	312 400 003*	110 – 230V/50 – 60Hz AC

\* Suitable for EPO central lubrication unit and EET 200 pump

### Programming diagram for 8-pin DIP switch

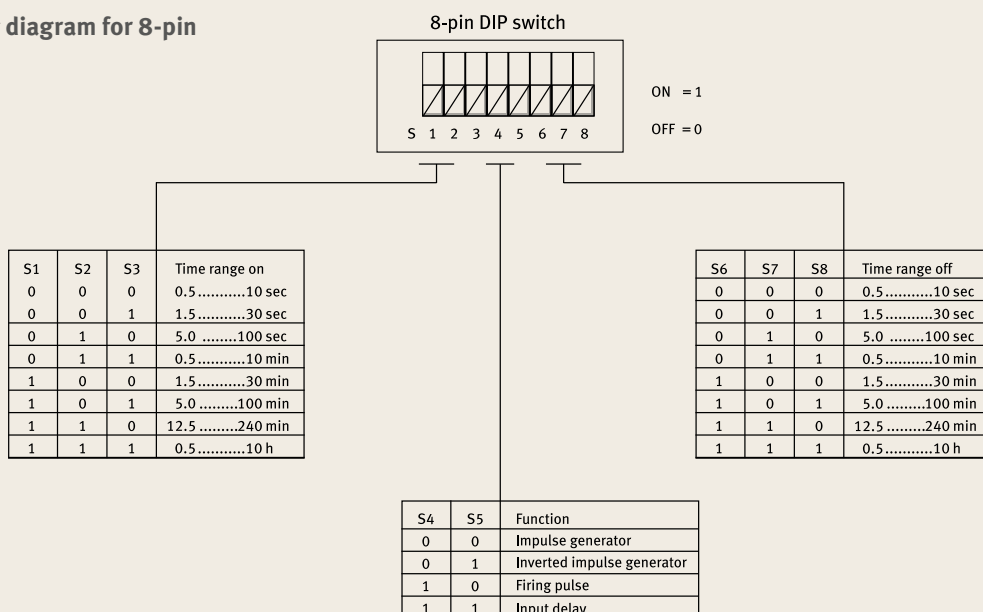

# MAGNETIC FLOAT SWITCH

- Perfect monitoring of fluids in storage tanks
- Hermetically enclosed contacts
- Contact-free actuation via magnetic field in float

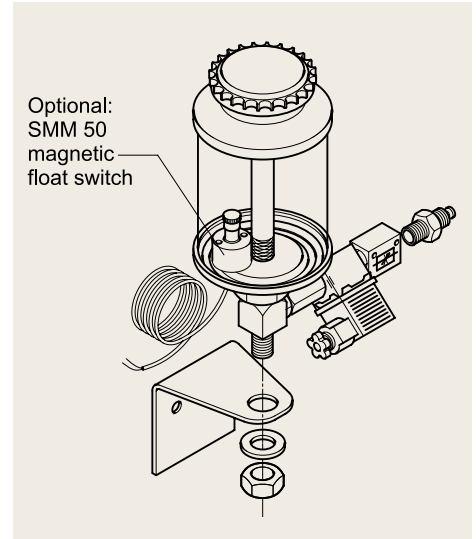
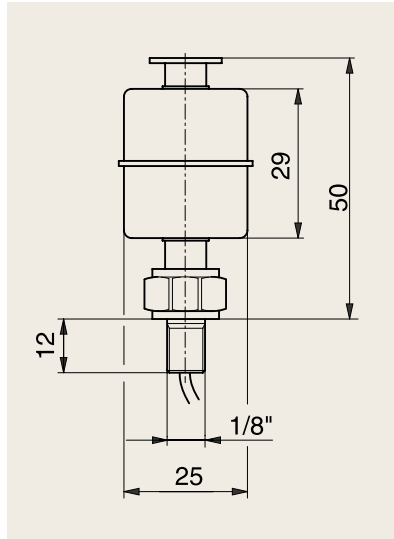

Type	Electrical connection	Cable	Temperature	Article no.
SMM 50	Max. voltage: 300V AC/DC 10 W* contact load	1 m LIYY 2 x 0.25mm <sup>2</sup>	-20 to +100°C	314 000 001*

\* Wired ready for connection in corresponding oil reservoir  
Switching function: Normally open contact

## Installation possible for:

Product	Design
ELO	1000 – 3000
EOS-B	1000 – 3000
MET-B	1000 – 3000
EOS-H	500 – 9000
MET-H	500 – 9000
OBH	500 – 9000
EPO	500 – 9000
UNI	100 – 150
MOS	500 – 9000

## Hoses/pipes

Product	Variant	ø D/d	Article no.	ø D/d	Article no.	ø D/d	Article no.
Hose	Soft PVC	5/8	312 900 001	5/8	312 900 002	10/8	312 900 003
Hose	Polyamide PA 12 W	5/8	312 900 004	5/8	312 900 005	10/8	312 900 006
Pipe	CU copper	5/8	312 900 007	5/8	312 900 008		

## OIL BRUSHES TYPE SPR

- Mount: Brass or aluminium
- Bristles: Perlon to 70°C, stainless steel from 70°C
- Undulating bristle structure prevents drip formation

Type	ø A	B*	C*	Perlon bristle article no.	Stainless steel bristle article no.
SPR 6,5	6,5	50	65	312 600 001	312 600 005
SPR 16	16	30	53	312 600 002	312 600 006
SPR 25	25	45	60	312 600 003	312 600 007
SPR 30	30	45	62	312 600 004	312 600 008

\* All dimensions in mm

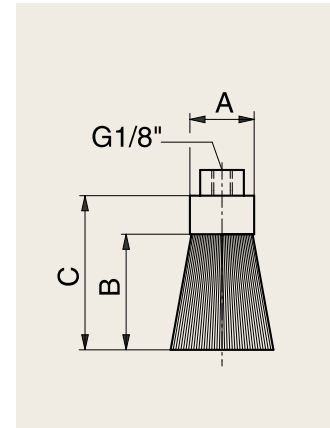

## OIL BRUSHES TYPE SPF

- Mount: Aluminium
- Bristles: Perlon to 70°C, stainless steel from 70°C
- Flat brushes available in various widths
- To achieve an even film of oil, we recommend that you use one oil dispenser per connection

Type	Perlon bristle article no.	Stainless steel bristle article no.
SPF 57	312 700 001	312 700 004
SPF 114	312 700 002	312 700 005
SPF 171	312 700 003	312 700 006

\* All dimensions in mm

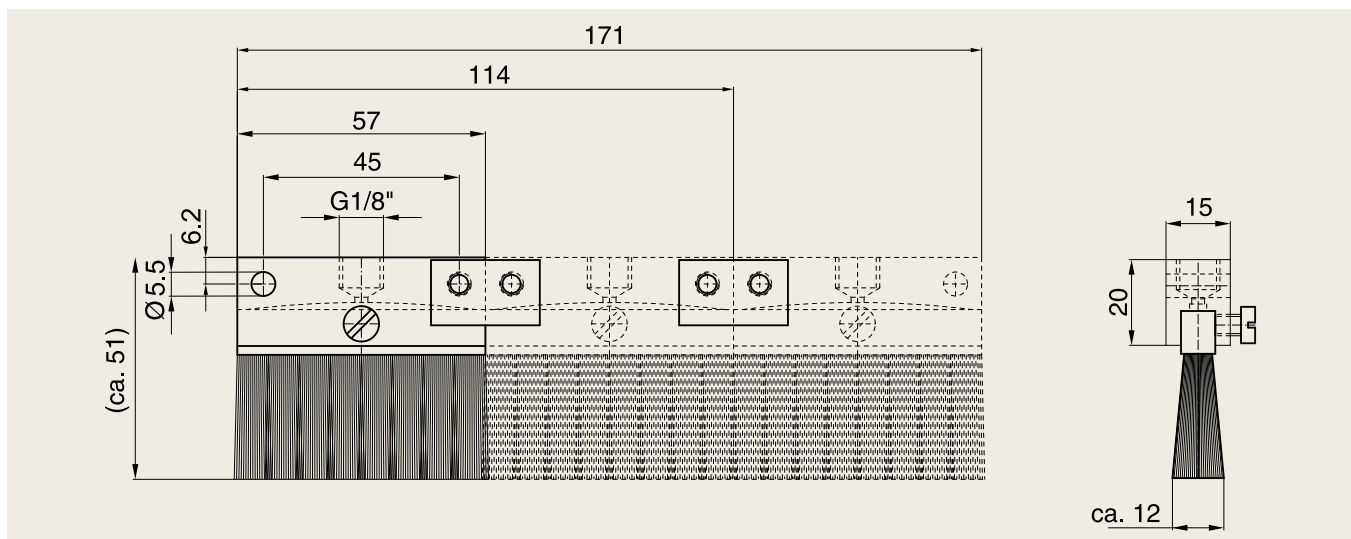

# ROLLER LUBRICATION UNITS TYPE RSM/RSM-B

## TYPE RSM

- For lubricating contact surfaces, chains, and so on
- Wheel brush for cleaning extremely dirty chains
- Bristles: Perlon to 70°C, stainless steel from 70°C

## TYPE RSM-B

- Oil supply from inside
- Variable mount with aluminium clamp on steel C section
- Hole pitch adapted for fastening bracket 1 (article no. 281090001) from Murtfeldt SPANN-BOX®-range (additional assembly aid)

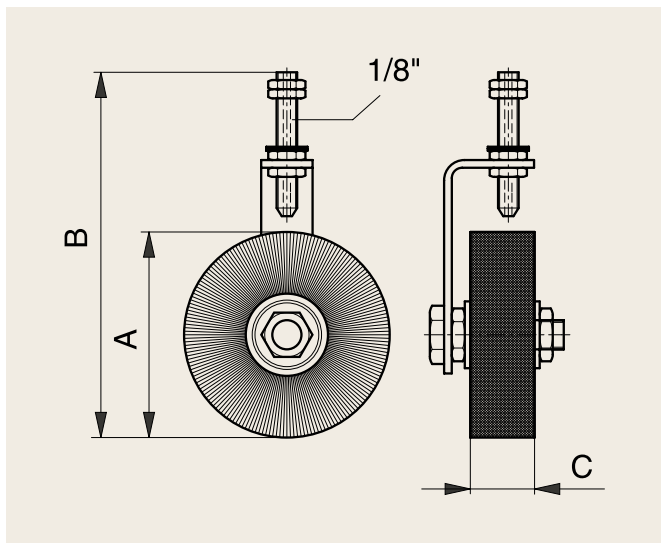

RSM 80

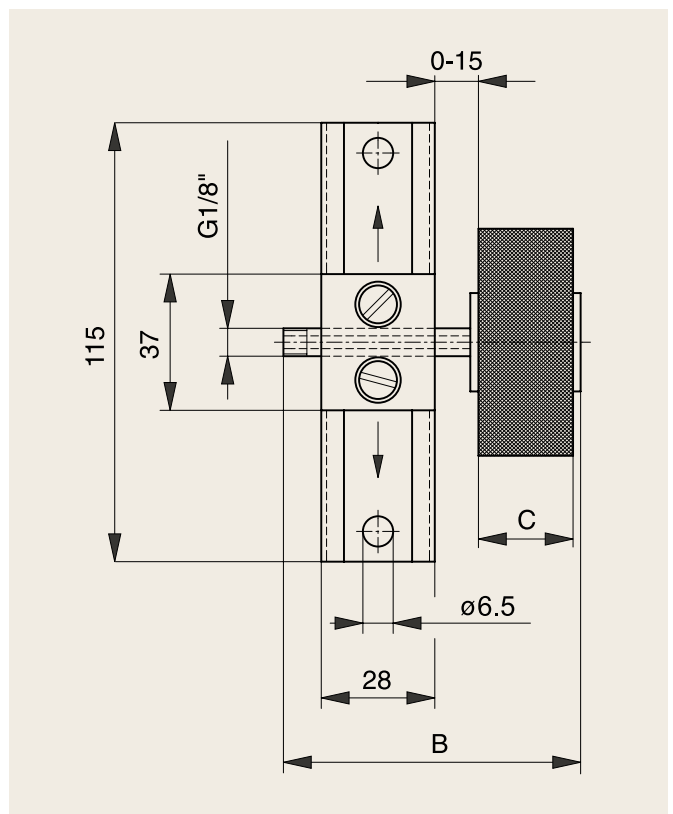

RSM-B

Type	A*	B*	C*	Perlon bristles article no.	Stainless steel bristles article no.
RSM 80	80	137	25	312 800 001	312 800 010
RSM-B 60/20	60	74	20	312 800 002	312 800 011
RSM-B 60/25	60	82	25	312 800 003	312 800 012
RSM-B 60/30	60	91	30	312 800 004	312 800 013
RSM-B 60/40	60	99	40	312 800 005	312 800 014
RSM-B 80/20	80	74	20	312 800 006	312 800 015
RSM-B 80/25	80	82	25	312 800 007	312 800 016
RSM-B 80/30	80	91	30	312 800 008	312 800 017
RSM-B 80/40	80	99	40	312 800 009	312 800 018

\* All dimensions in mm

# FASTENING BRACKETS, BRUSH HOLDERS, MOUNTING RAILS

## Fastening bracket BWK

Galvanized steel, for brush holder PHA  
Article no.: 313 600 001

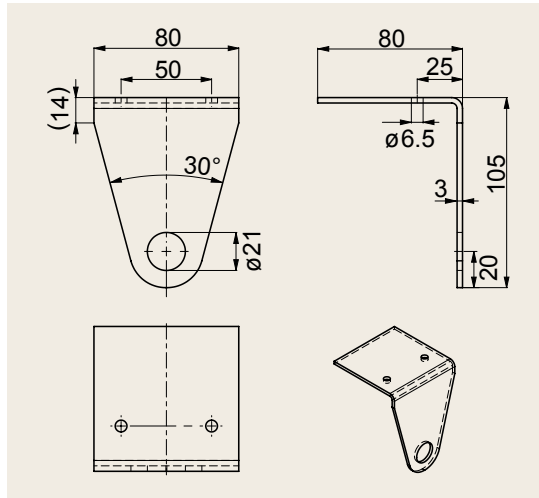
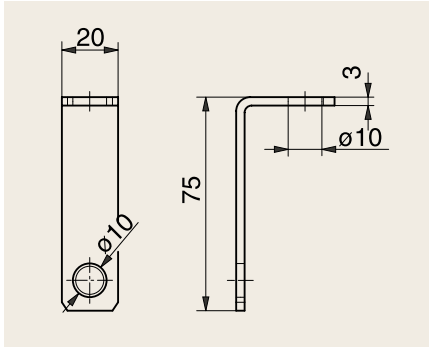

## Fastening bracket BWG

Galvanized steel, for oil reservoirs up to 3,000 ml,  
L = 105 mm  
Article no.: 313 600 004

## Brush holder

Brass, nickel-plated

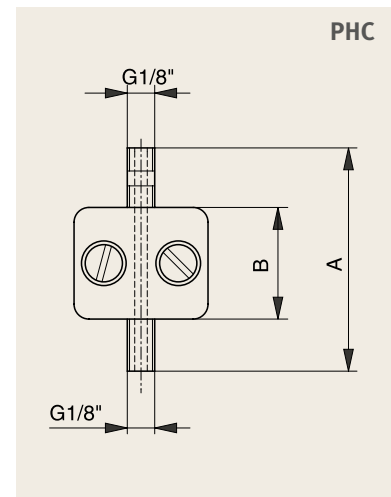
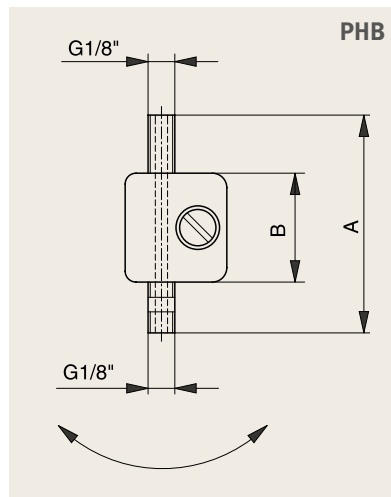
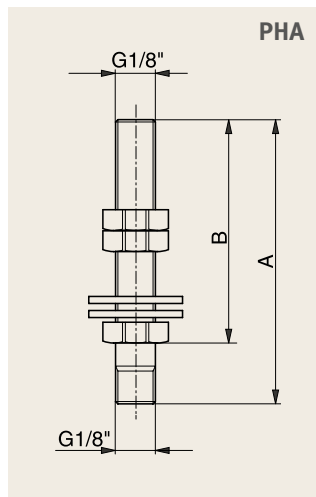

	Type	A*	B*	Thread	Article no.
Height adjustment via thread	PHA 60	60	47	G 1/8"	313 000 001
	PHA 80	80	47	G 1/8"	313 000 002
	PHA 120	120	47	G 1/8"	313 000 003
Height adjustment via clamping device; for attachment on a mounting rail; pivotal	PHB 60	60	30	G 1/8"	313 000 004
	PHB 80	80	30	G 1/8"	313 000 005
	PHB 120	120	30	G 1/8"	313 000 006
Rigid design; height adjustment via clamping device	PHC 60	60	30	G 1/8"	313 000 007
	PHC 80	80	30	G 1/8"	313 000 008
	PHC 120	120	30	G 1/8"	313 000 009

\* All dimensions in mm

## Mounting rail

Steel type C5, galvanized – or in stainless steel, for PHB and PHC. Standard length 2 m, other lengths on request

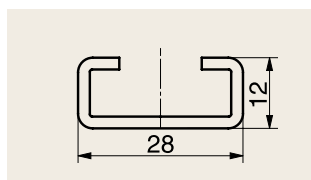

Steel C section, type C5, galvanized  
2,000mm long, tolerances in accordance  
with DIN 59413

Article no.: 351 020 005 In V2A: 351 020 105



# FITTINGS

## For copper pipe

### Straight screwed coupling

Brass, nickel-plated

Type	For ED* pipe	Connection G	L1*	i*	l*	D1*	S1*	S*	Article no.
851M - 6 <sup>1</sup> / <sub>8</sub>	6	G <sup>1</sup> / <sub>8</sub> "	21.5	6	12.5	-	12	13	313 100 001
851M - 8 <sup>1</sup> / <sub>8</sub>	8	G <sup>1</sup> / <sub>8</sub> "	25.0	6	14.0	15.5	13	14	313 100 002
851M - 6 <sup>1</sup> / <sub>4</sub>	6	G <sup>1</sup> / <sub>4</sub> "	22.0	8	13.0	-	12	17	313 100 012
851M - 8 <sup>1</sup> / <sub>4</sub>	8	G <sup>1</sup> / <sub>4</sub> "	25.5	8	14.5	15.5	13	17	313 100 013

\* All dimensions in mm

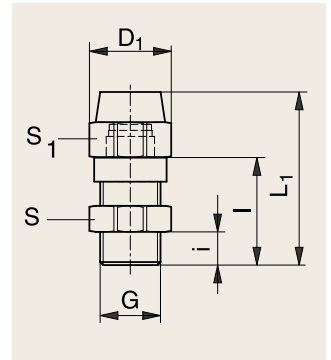

### Straight female coupling

Brass, nickel-plated

Type	For ED* pipe	Connection G	L1*	i*	l*	D1*	S1*	S*	Article no.
846M - 6 <sup>1</sup> / <sub>8</sub>	6	G <sup>1</sup> / <sub>8</sub> "	27.0	8	18.0	-	12	13	313 100 003
846M - 8 <sup>1</sup> / <sub>8</sub>	8	G <sup>1</sup> / <sub>8</sub> "	30.5	8	19.5	15.5	13	14	313 100 004

\* All dimensions in mm

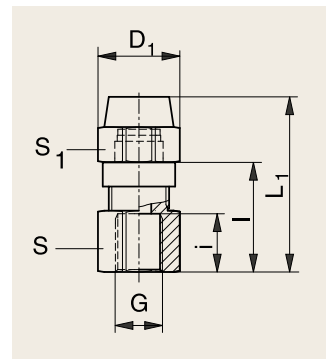

### Angled screwed coupling (bevelled)

Brass, nickel-plated

Type	For ED* pipe	Connection G	L1*	i*	l*	D1*	S1*	S*	Article no.
850M - 6 <sup>1</sup> / <sub>8</sub> K	6	<sup>1</sup> / <sub>8</sub> K	24.0	17	8.8	15.0	12	8	313 100 005
850M - 8 <sup>1</sup> / <sub>8</sub> K	8	<sup>1</sup> / <sub>8</sub> K	28.5	17	7.5	15.5	13	10	313 100 006

\* All dimensions in mm

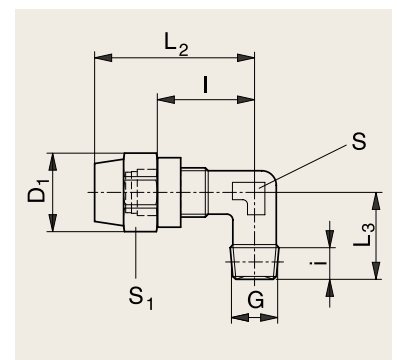

### Angled female coupling

Brass, nickel-plated

Type	For ED* pipe	Connection G	L1*	L1*	i*	l*	D1*	S1*	S*	Article no.
849M - 6 1/8	6	G 1/8"	24.0	20	8	15.0	-	12	10	313 100 007
849M - 8 1/8	8	G 1/8"	28.5	20	8	17.5	15.5	13	10	313 100 008

\* All dimensions in mm

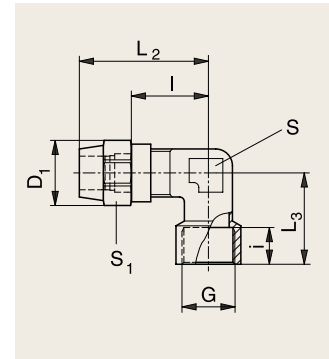

### T fitting

Brass, nickel-plated

Type	For ED* pipe	L2*	i*	D1*	S1*	S*	Article no.
845M - 6	6	24.0	15.0	-	12	8	313 100 009
845M - 8	8	28.5	17.5	15.5	13	10	313 100 010
845M - 10	10	37.5	23.0	20.0	17	13	313 100 011

\* All dimensions in mm

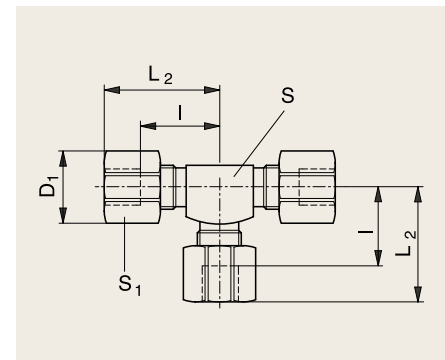

# FITTINGS

For PVC and PA 12W hose

## Straight screwed couplings

Brass, nickel-plated

Type	For D/d pipe	Connection G	Nominal width*	L1*	i*	D1*	S1*	S*	Article no.
151M - 6/4 - 1/8	6/4	G 1/8"	3.3	18.5	6	11.5	10	13	313 200 001
151M - 8/6 - 1/8	8/6	G 1/8"	5.3	18.5	6	13.5	12	13	313 200 002
151M - 10/8 - 1/8	10/8	G 1/8"	5.1	20.0	6	15.5	13	14	313 200 003
151M - 6/4 - 1/4	6/4	G 1/4"	3.3	19.0	8	11.5	10	17	313 200 021
151M - 8/6 - 1/4	8/6	G 1/4"	5.3	19.0	8	13.5	12	17	313 200 022
151M - 10/8 - 1/4	10/8	G 1/4"	7.0	20.5	8	15.5	13	17	313 200 023

\* All dimensions in mm

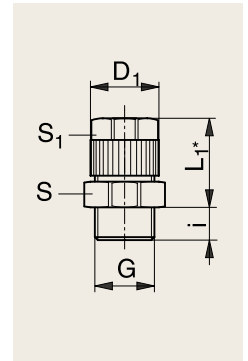

## Straight female couplings

Brass, nickel-plated

Type	For D/d pipe	Connection G	Nominal width*	L1*	i*	l*	d1*	D1*	S1*	S*	Article no.
146M - 6/4 - 1/8	6/4	G 1/8"	3.3	24	8	-	5.5	11.5	10	13	313 200 004
146M - 8/6 - 1/8	8/6	G 1/8"	5.3	24	8	7	5.5	13.5	12	13	313 200 005

\* All dimensions in mm

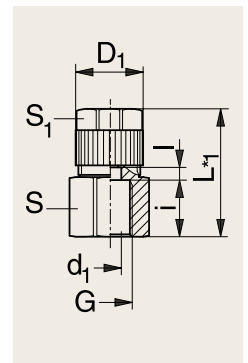

## Angled screwed couplings (bevelled)

Brass, nickel-plated

Type	For ED* pipe	Connection G	Nominal width*	L2*	L3*	i*	D1*	S1*	S*	Article no.
150M - 6/4 - 1/8K	6/4	1/8K	3.3	21.5	17	7.5	11.5	10	8	313 100 006
150M - 8/6 - 1/8K	8/6	1/8K	4.6	21.5	17	7.5	13.5	12	8	313 100 007
150M - 10/8 - 1/8K	10/8	1/8K	5.6	24.0	17	7.5	15.5	13	10	313 100 008

\* All dimensions in mm

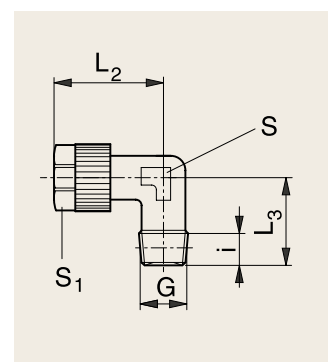

## Angled female couplings

Brass, nickel-plated

Type	For D/d pipe	Connection G	Nominal width*	L2*	L2*	i*	D3*	D1*	S1*	S*	Article no.
149M - 1/4 - 1/8	1/4	G 1/8"	3.3	22.5	20	8	13	11.5	10	10	313 200 009
149M - 3/8 - 1/8	3/8	G 1/8"	5.3	22.5	20	8	13	13.5	12	10	313 200 010

\* All dimensions in mm

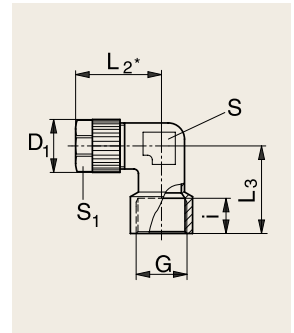

## T screwed coupling (bevelled)

Brass, nickel-plated

Type	For D/d pipe	Connection G	Nominal width*	L2*	L3*	i*	D1*	S1*	S*	Article no.
141M - 1/4 - 1/8K	1/4	1/8K	3.3	21.5	17	7.5	11.5	10	8	313 100 011
141M - 3/8 - 1/8K	3/8	1/8K	4.6	21.5	17	7.5	13.5	12	8	313 100 012
141M - 10/8 - 1/8K	10/8	1/8K	5.6	24.0	17	7.5	15.5	13	10	313 100 013

\* All dimensions in mm

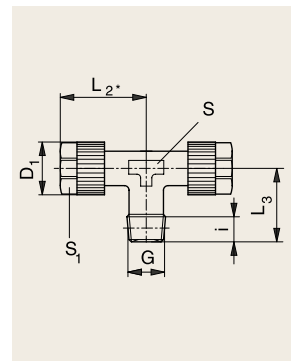

## T fittings

Brass, nickel-plated

Type	For ED/d pipe	Connection G	Nominal width*	L2*	L7*	D1*	S1*	D2*	S2*	S*	Article no.
154M - 1/4	1/4	1/4	3.3	21.5	21.5	11.5	10	11.5	10	8	313 200 014
154M - 3/8 - 1/4	3/8	1/4	5.3/3.3	21.5	21.5	13.5	12	11.5	10	8	313 200 015
154M - 3/8	3/8	3/8	5.3	21.5	21.5	13.5	12	13.5	12	8	313 200 016
154M - 10/8 - 1/4	10/8	1/4	7/3.3	24.0	23.0	15.5	13	11.5	10	10	313 200 017
154M - 10/8 - 3/8	10/8	3/8	7/5.3	24.0	23.0	15.5	13	13.5	12	10	313 200 018
154M - 10/8	10/8	10/8	7	24.0	24.0	15.5	13	15.5	13	10	313 200 019

\* All dimensions in mm

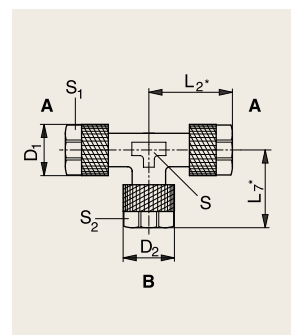

### Reducing nipple (cylindrical)

Brass, nickel-plated

Type	Connection G1	Connection G2	L1*	i1*	S*	Article no.
252M - 1/8 - 1/4	G 1/8 "	G 1/4 "	19.0	6	17	313 300 001
252M - 1/8 - 3/8	G 1/8 "	G 3/8 "	20.0	6	19	313 300 002
252M - 1/8 - 1/2	G 1/8 "	G 1/2 "	24.0	6	24	313 300 003
253M - 1/4 - 1/8	G 1/4 "	G 1/8 "	13.0	8	17	313 300 004
253M - 3/8 - 1/8	G 3/8 "	G 1/8 "	14.0	9	19	313 300 005
253M - 1/2 - 1/8	G 1/2 "	G 1/8 "	15.5	10	24	313 300 006

\* All dimensions in mm

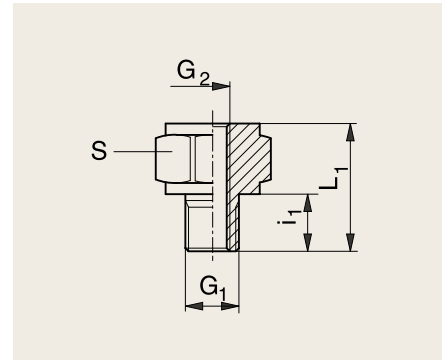

### Double nipple

Brass, nickel-plated

Type	G1	G2	L	S	Article no.
250M - 1/8	1/8"	1/8"	16.5	13	314 100 001
251M - 1/8 K - 1/4 K	1/8 K	1/4 K	23.5	14	314 100 002
251M - 1/4 K - 3/8 K	1/4 K	3/8 K	27.5	17	314 100 003
250M - 1/8 K	1/8 K	1/8 K	19.5	10	314 100 004

\* All dimensions in mm

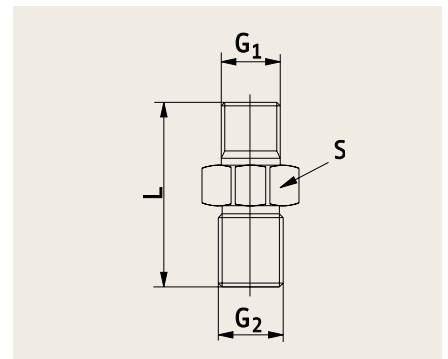

### Angle pieces (cylindrical)

Brass

Type	Connection G	Article no.
303W - 1/8	G 1/8 "	313 400 001

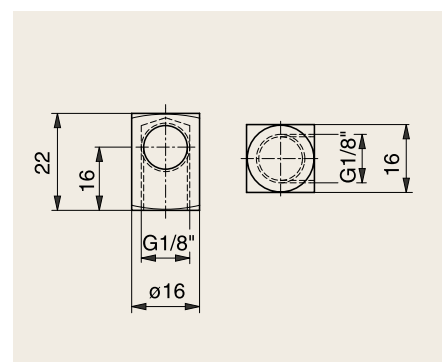

# NOTES











